

REPRODUCING THESE DRAWINGS BY PRINTING OR COPYING MAY LEAD TO ERRORS. PLEASE REFER TO SCALE BAR. DO NOT SCALE OFF THESE DRAWINGS FOR CONSTRUCTION PURPOSES. IF ANY DISCREPANCIES ARE FOUND, PLEASE CONTACT WESTERN DESIGN ARCHITECTS IMMEDIATELY.

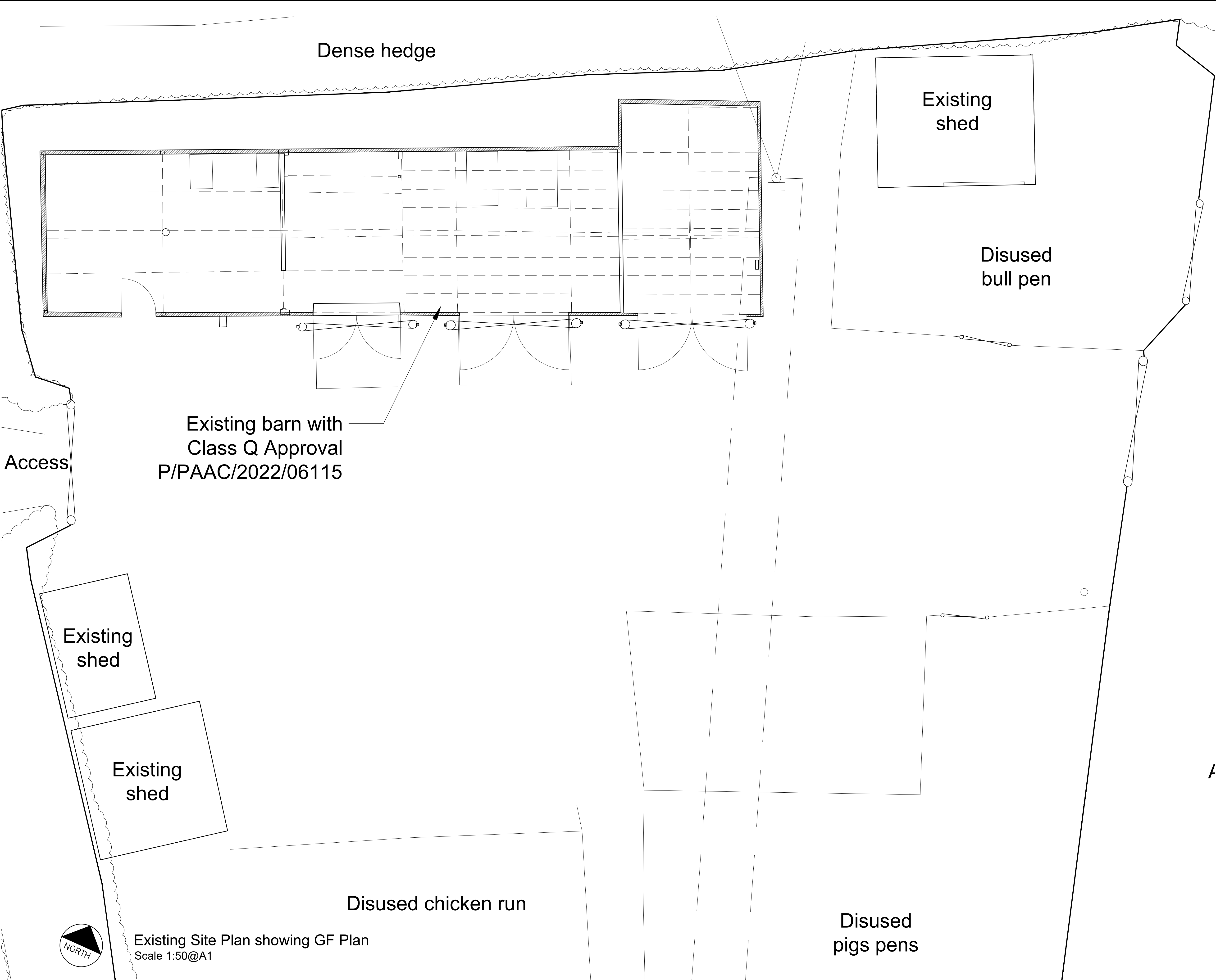

Existing Site Plan showing GF Plan  
Scale 1:50@A1

**DESIGNERS RISK ASSESSMENT-  
HEALTH AND SAFETY**  
THE CONSTRUCTION (DESIGN AND MANAGEMENT) REGULATIONS 2015

For significant hazards specific to the project please refer to Drawing CDM01 where appropriate

**NOTES:-**

**NOTES FEASIBILITY SKETCHES**

Please note: this sketch is based on limited information and subject to the following list of consultants, reports and searches that should be instructed/consulted as soon as possible to confirm the validity of this feasibility (this list is not exhaustive):

- 1) Site Ownership
- 2) topographical survey
- 3) tree constraints plan by qualified consultant
- 4) local and utility searches
- 5) local policies and constraints; e.g flood zones, SSSI's, conservation areas etc.
- 6) Ecology
- 7) Ground Contamination

REV.	REVISION DETAILS	BY	CKD	DATE

**WDA**  
westerndesignarchitects.com

**Western Design Architects**  
12 The Granary, Hinton Business Park, Tanqueray Hinton, Dorset, DT11 8JF  
T:01258 830675 E:info@westerndesign.co.uk

CLIENT		
Wanda and Paul Stainer		
PROJECT		
The Cow Shed, Holt Lane		
DRAWING TITLE		
Existing Site Plan showing GF Plan		
DRAWN BY	CHECKED BY	DATE
EG	PE	15.12.2022
SCALE	JOB NO.	
1:50@A1	2223017	
DRAWING NO.	REVISION	
103	-	
PLANNING		
THIS DRAWING IS COPYRIGHT © Western Design Ltd 2023		