

BUILD UP EXTERNAL WALLS AS FOLLOWS:
 WESTERN RED CEDAR VERTICAL BOARDING NAILED WITH ALLOY NAILS
 38mm x 50mm TANGLED BATTENS SCREWED TO BLOCKWORK/25mm HORIZONTAL BATTENS
 100mm CONCRETE BLOCK
 100mm KINGSPAN KOOLTHERM K106 FULL FILL CAVITY BOARD
 10mm RESIDUAL CAVITY
 100mm CELCON SOLAR INSULATION BLOCK
 HRT4 STAFFIX STAINLESS STEEL WALL TIES COMPLETE WITH RETAINING CLIPS
 POSITIONED 450mm VERTICALLY AND 750mm HORIZONTALLY.
 10mm RENDER & 3mm MULTI-FINISH PLASTER SKIM COAT
 'U' VALUE 0.16W/m2/K

SHOWER CUBICLE
 WITHIN EXISTING RECESS BLOCK UP OPENING WITHIN CLOAKROOM WITH
 TIMBER STUDWORK CLAD WITH BACKERBOARD & INCLUDE FOR SHELF
 RECESS AT 1000mm HIGH FOR BOTTLES ETC.

PROVIDE DOUBLE SEAL INSPECTION CHAMBER COVER WITH
 HOLDING DOWN BOLTS
 COVER 75.680
 INVERT 74.960

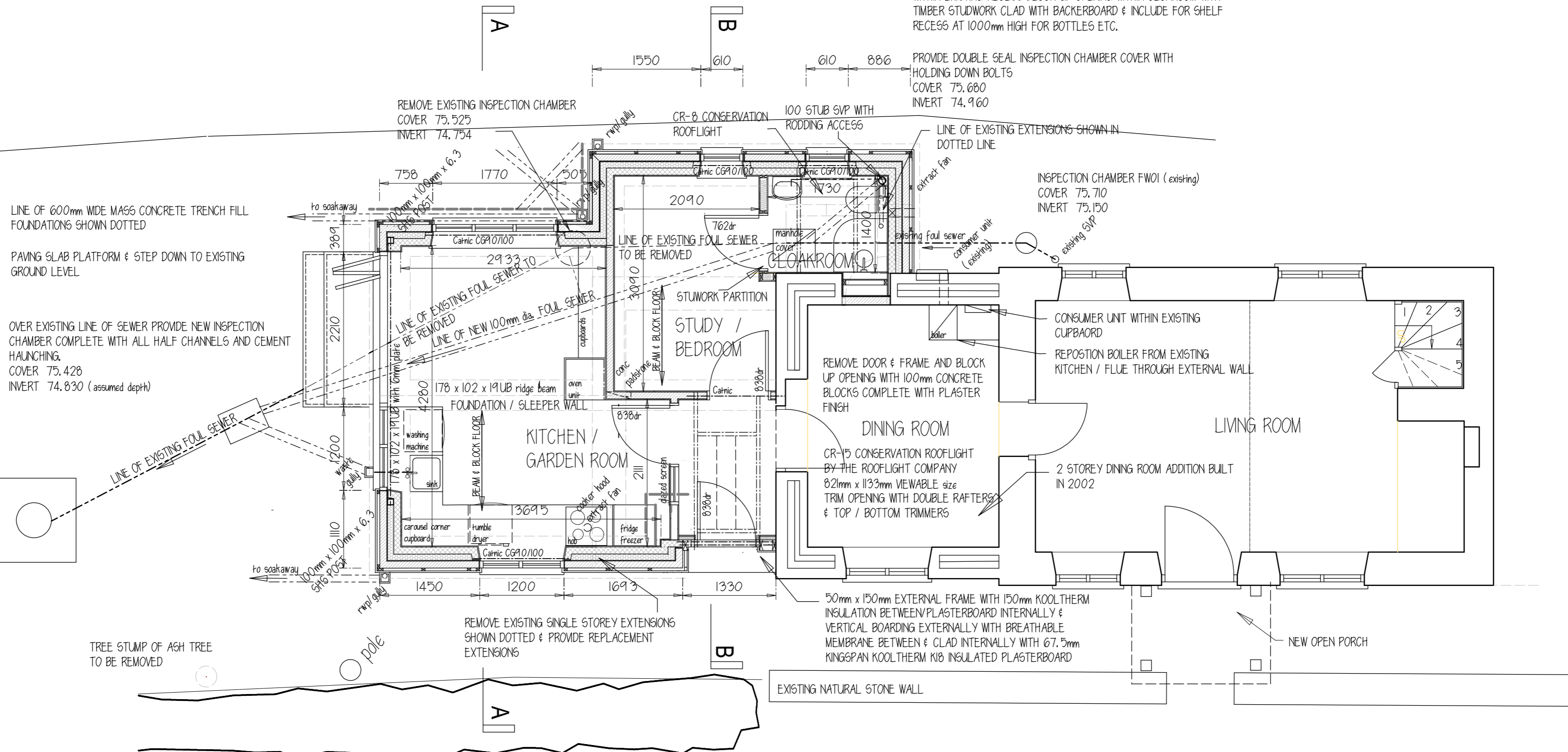

GROUND FLOOR PLAN - proposed

GROUND FLOOR PLAN

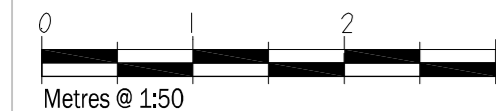

	PAUL GALE mcia	planning + architectural design ltd	
	Willows End Glebe Close Thomford Sherborne Dorset DT9 6PY tel: 01935 872056 e-mail: paul.gale2@btinternet.com		
Client:	Mrs E Howat	Project:	Proposed single storey extensions & internal alterations
Address:	Rose Cottage, Bere Lane, Caundle Marsh, Sherborne, Dorset DT9	drawg no:	21.987.10
Drawing:	Ground Plan - proposed	scale:	1:50 @ A2
		revision:	B
		date:	June 2022
		drawn:	P Gale

© copyright
 DO NOT SCALE FROM DRAWINGS REFER TO DIMENSION ONLY. CHECK ALL DIMENSIONS ON SITE PRIOR TO COMMENCING THE WORK
 CONSTRUCTION TO COMPLY WITH CURRENT BUILDING REGULATIONS & BRITISH STANDARDS & MANUFACTURERS' DETAILS